



**Democracy Services
London Borough of Merton
Merton Civic Centre
London Road
Morden SM4 5DX**

**Direct Line: 0208 545 3357
Email: democratic.services@merton.gov.uk**

Date: 3 December 2021

Dear Councillor

**Notification of a Decision taken by the Cabinet Member for Housing,
Regeneration and the Climate Emergency**

The attached non-key decision has been taken by the Cabinet Member for Housing, Regeneration and the Climate Emergency with regards to:

School Streets – EMTO results- Aragon Primary School

and will be implemented at **noon on Wednesday 8 December 2021** unless a call-in request is received.

The [call-in](#) form is attached for your use if needed and refers to the relevant sections of the constitution.

Yours sincerely

Democracy Services

NON-KEY DECISION TAKEN BY A CABINET MEMBER UNDER DELEGATED AUTHORITY

See over for instructions on how to use this form – all parts of this form must be completed. Type all information in the boxes. The boxes will expand to accommodate extra lines where needed.

Title of report: School Streets – EMTO results- Aragon Primary School

Reason for exemption (if any) – N/A

Decision maker

Councillor Martin Whelton, Cabinet Member for Housing, Regeneration & the Climate Emergency

Date of Decision

3 December 2021

Date report made available to decision maker

19th November 2021

Decision

Having considered the officer's recommendations and all the representations, I agree to the recommendations as set out in the report in making the school street permanent and for a statutory consultation to be undertaken to change the hours of operation to 8.15– 9.00am and 2.45 – 3.45pm Mon-Fri term times only

Reason for decision

To maintain and further improve on reducing congestion, risk, pollution outside school gate and continue to encourage active travel and bring about a change in behaviour.

Alternative options considered and why rejected

To remove the restrictions. This would be against the Council's objectives in improving the environment in terms of safety, access, air quality and increase in active travel and use of sustainable transport. It will do nothing to address localised congestion.

Documents relied on in addition to officer report

N/A

Declarations of Interest

N/A

Cllr Martin Whelton
Cabinet member for housing, regeneration, and the climate emergency
3 December, 2021

Committee: Cabinet Member Report

Date: 19 November 2021

Agenda item: N/A

Wards: Lower Morden

Subject: School Streets – EMTO results- Aragon Primary School

Lead officer: Chris Lee, Director of Environment & Regeneration.

Lead member: Councillor Martin Whelton, Cabinet Member for Housing, Regeneration and the Climate Emergency

Forward Plan reference number: N/A

Contact Officer: Mitra Dubet, email: mitra.dubet@merton.gov.uk

Recommendations:

That the Cabinet Member considers the issues detailed in this report and:

- A) Notes the results of the Experimental Traffic Management Order used to implement the School Street and its associated restrictions as shown below and on plan in Appendix 1.

School	Restricted Roads	Restricted periods Mon-Fri Term times only
Aragon Primary	Aragon Rd (between Kingsbridge Rd & Cleveland Rise) Aragon Place	8.00 – 9.15am 2.45 - 4.00pm

- B) To consider all the representations received as set out in Appendix 2 and agrees to proceed with making the existing Experimental Traffic Management permanent.
- C) Agrees to the undertaking of a statutory consultation to change the hours of operation to 8.15– 9.00am and 2.45 – 3.45pm Mon-Fri term times only (to reflect the schools' new hours).
- D) Agrees to exercise his discretion not to hold a public inquiry on the consultation process.

1. PURPOSE OF REPORT AND EXECUTIVE SUMMARY

- 1.1 This report details the result of the Experimental Traffic Management Order used to introduce the School Street restrictions in September 2020.
- 1.2 It seeks approval to proceed with making the Experimental Traffic Management Order (ETMO) permanent and retain the School Street. This will ensure that the objectives associated with school streets are met and retained.
- 1.4 This report also seek approval to undertake a statutory consultation to change the hours of operation to 8.15– 9.00am and 2.45 – 3.45pm Mon-Fri term times only.

2.0 DETAILS

- 2.1 As part of the Council's objective to reduce congestion, pollution, collisions, risk and provide a safe environment within the vicinity of schools, the Council has a rolling road safety and accessibility programme. Measures that are often implemented include 'school keep clear' zig-zag road markings to prevent drivers parking close to the school gates and to improve sightlines; 20mph speed limits with accompanying traffic calming measures and road safety education. These measures have been very successful in most areas, as there has been an improvement in perception of safety with a reduction in risk of injury. Although these measures have been successful in ensuring access and safety, the level of congestion, risk and air quality outside the schools remain a concern. The contributing factor is the high- localised volume of vehicular traffic and obstructive parking within the vicinity of schools often generated by parents / carers of pupils attending the school.

Air Quality

- 2.2 To assess the level of air quality around schools, in January 2017 the Mayor of London commissioned an assessment of air quality outside 50 London schools. A report was published in May 2018 (the Mayor of London on School Air Quality Programme) detailing its findings of unacceptable levels of air quality during the school opening and closing periods of the day. One of the contributing factor to this poor air quality within London is road transport, of which the Mayor of London has introduced a series of measures to improve the air quality especially around schools, however this still remains a concern. It is considered that without significant intervention, as the Capital grows rapidly with increasing congestion, adverse health and safety implications are set to continue.
- 2.3 The Mayor's Air Quality report also identified that school travel in some areas often does not contribute substantially to local emissions, as many walk, scoot, cycle or travel by public transport, with much of the road transport emissions emanating from the nearby busy main roads. However, seeking to manage and reduce school related car travel still has an important role to play. Cars picking up and dropping off children near the school gates result in a concentration of emissions amongst larger numbers of children, worsening exposure including the increase in risk of collisions. The recommendations also often focus on delivering broader improvements to the environment around the schools for walking and cycling, and the promotion of sustainable transport including footway widening, kerb build-outs, improved crossing facilities on desire lines and traffic calming.
- 2.4 The Mayor's Air Quality report highlights that without significant intervention, as the capital grows rapidly with increasing congestion, the air quality levels are forecast to rise considerably, which will impact on adverse health and safety implications. Health implications include triggering or exacerbating chronic diseases such as asthma, hearth attack, bronchitis and other respiratory problems.
- 2.5 Recommendations in the Mayor's report is for local authorities to try and minimise the level of pollution outside schools by introducing measures to minimise vehicular traffic outside school gates. Due to the pandemic, since May 2020, all local authorities have been encouraged to expedite such improvements.
- 2.6 In addition to the above, in response to a green recovery, DfT / TfL provided funding (subject to a bid process) for boroughs to consider, consult and implement School Streets so as to reduce congestion, remove the obstructive parking that is often associated with schools; promote active and sustainable modes of travel; improve safety and air quality particularly outside schools. Further information is available on the Council's website www.merton.gov.uk/schoolstreets
- 2.7 During tranche 1 of the funding process, the Council was successful in its bid to DfT/TfL in securing funding to design and implement a number of school streets throughout the borough. However, due

to extremely tight deadlines set by TfL/DfT, the programme was introduced under an Experimental Order. As per legislation, the Council does need to make a decision no later than 18th month of the ETMO coming in to effect.

2.8 As part of Merton’s commitment, a report dated 3rd August 2020 titled School Streets–Restricted Vehicular Access -Experimental Traffic Management was submitted to the Cabinet Member for approval to implement a number of school streets. Cabinet Member decision was made to implement the school street under an Experimental Order.

2.9 Although it is normal practice to undertake before and after surveys that can be used for an impact assessment, particularly on the neighbouring roads, due to the pandemic / lock down and a general change in traffic pattern and behavior, any survey at the time would not have yielded a true reflection.

3.0 SCHEME

3.1 To achieve a number of objectives such as improving safety and air quality and encourage active travel, the Council introduced a school street within the following roads. The school street restricts motorised traffic during specific times based on schools’ starting and finishing times. The restrictions only apply during school term periods.

School	Restricted Roads	Restricted periods Mon-Fri Term times only
Aragon Primary	Aragon Rd (between Kingsbridge Rd & Cleveland Rise) Aragon Place	8.00 – 9.15am 2.45 - 4.00pm

3.2 Initially the Council intended to use a default period of 08.15 - 09.15am and 15.00-16.00hrs. However, the restricted hours were based on the schools’ then adopted opening / closing hours. Being mindful of the fact that parents often arrive earlier than the starting and finishing times, it was considered necessary to extend the initial proposed hours by 15 minutes.

3.3 During these periods, the roads as set out within the above table are predominately ‘pedestrian and cycle only’ zone. Residents who live in the affected roads are allowed vehicular access as are teachers and those with special needs children who need to be driven to school. This is via an on-line exemption process. Others who may also qualify for an exemption can also register with the Council; exemptions are subject to meeting the appropriate criteria. Location plan and exemption catchment area are attached as appendix 1.

4. CONSULTATION

Statutory Consultation

4.1 Due to extremely tight deadlines set by TfL/DfT, the programme was introduced under an Experimental Order. This type of Order enables the implementation of a scheme during the statutory consultation stage. An Experimental Order allows the restrictions and the Order to be in place for a maximum of 18 months before a final decision is made. Anyone can make a representation within the first six months (the statutory/formal consultation period) of the Experimental Order coming into force. The EMTO allowed the Council to meet its extremely tight deadlines but more importantly, it enabled the school, residents and other road users to experience the restrictions, thereby allowing them to make an informed decision prior to responding to the consultation. It also allows the Council to make minor adjustments. Consultees had in excess of 6 months to respond to the consultation and residents were encouraged to allow sufficient time to experience the scheme before making a representation.

- 4.2 The consultation began on 9th September 2020 and concluded on 31st July 2021. Newsletters were delivered to 157 properties (see plan in appendix 3). The newsletter detailed the consultation process; the proposed measures and a location plan. A copy of the newsletter with the plan is attached in Appendix 1.
- 4.3 Residents were encouraged to submit their feedback on the Council's website using specific on-line feedback link. All available information was also posted on the website. [Introducing new school streets 2020 \(merton.gov.uk\)](#). Street notices were erected on lamp columns and published in the local papers and the London Gazette.
- 4.3.1 In terms of publicising the school streets programme there was an article on School Streets in My Merton magazine [the Winter 2020 edition](#). This copy was distributed to all households in Merton from 19 November 2020. There was also a news article about it in [the Spring 2021 edition](#) which was published on 25 March 2021.
- 4.3.2 The school was provided with a banner to be attached to the school gate. The banner set out the details of the restrictions and affected roads. The school was also requested to inform and remind parents of the restrictions.
- 4.4 After removing blanks and those without an address and combining multiple entries from the same person, the statutory consultation resulted in a total of 73 representations. These include 58 representations from within the newsletter postal area, of which 19 are in support of the scheme and 39 objections. This means that 75% of residents do not object to the scheme. All responses are detailed in Appendix 2.
- 4.5 Additionally there are 15 representations from outside the newsletter postal area, of which one is in support and 14 objections. All responses are detailed in Appendix 2.
- 4.6 It is essential to note that when making a decision based on the outcome of a statutory consultation, consideration must be given to the validity of objections rather than the number of objections.
- 4.7 The most common theme from the comments, from supporters as well as objectors relate to the imposed inconvenience on residents' daily lives with respect to deliveries, visitors, tradespeople, carers, vulnerable/disabled people, taxis and hire vehicles. Objections do reveal misunderstandings about the scheme that impede its acceptance; there appears to be a lack of understanding about the level of exemptions available for residents and flexibility in accommodating certain scenarios albeit inconvenient.
- 4.7.1 The second most common theme across the board relates to the problem being displaced into surrounding roads causing danger, pollution and inconvenience in those areas, and it is not stopping parents from driving their children to school.
- 4.7.2 Those in support generally cited the reasons given in the consultation documentation, in that they felt it would reduce pollution and congestion, increase safety for school children.
- 4.8 In response to the points raised above:
- One of the objective is to deter car trips for 'the school run', which is a major source of congestion and poor air quality outside schools as well as on route to and from schools. In the past the Council has attempted to address school related traffic and parking issues through School's travel plan, Road safety Education and parking management. However, it has become very clear that a more stringent action is required to change the behavior of parents and motorists in general. A school street can be an effective method of bringing about this change.
 - It is appreciated that some parents continue to resist the change and have found their way

into neighbouring roads. In the absence of a CPZ enforcement is proving difficult as currently only obstructive parking can be enforced. Although due to the number of schools and limited staff it is not possible to provide daily enforcement for every school, routine enforcement is carried out on a rota basis with targeted enforcement in some areas. With continued enforcement, it is considered that there will be a change in behavior albeit at a slower pace than expected.

- In response to those who have asked for better enforcement, due to limited available funding and the number of school streets, it has not been possible to have a fixed camera in place across all school streets. However, if the scheme is made permanent, consideration will be given to procuring additional ANPR cameras. Meanwhile apart from the ANPR cameras operating on a rotation system, the Council is also undertaking mobile enforcement. Obstructive parking cannot be undertaken via ANPR and this area is on a rota for enforcement.
- Due to the pandemic and various guidelines, at the time of the implementation of the scheme, many schools had to establish some form of staggered hours which had to be accommodated within the restrictions. However, the school has advised the Council of its new hours and if the scheme is made permanent, a statutory consultation will be undertaken to reflect the new school hours. The hours will allow at least 15 additional minutes to capture the many parents who arrive early particularly during afternoon pick up periods.
- The legal signs plus advance signs have been in place since Sept / Oct 2020 and are clearly visible. The signs at the entrance to the restricted roads fully comply with the Traffic Signs Regulations and General Directions (TRSGD) (2016) and are also included in the Highway Code. School streets signs and restrictions are no different to any other moving contravention signs that motorists are obligated to abide by. These signs are used across London and motorists should be familiar with them and abide by them accordingly.

A full assessment of all school street signage across the borough has been carried out and arrangements have been made to further improve the signage in terms of numbers, position and visibility across the borough. This would be over and above of is actually required and considered as necessary. If the scheme is made permanent, 'Term Time only' supplementary plates will be added to the main entry signs. All advance signs which already include this text are being redesigned as more of a pictorial sign, thereby making it easier for drivers to observe.

- Residents who are directly affected by the restrictions (except for very few) were informed of the restrictions and they are exempt by undergoing the registration process. All vehicles registered to the address can be registered for exemption. In terms of *affected* residents, only those who have no alternative vehicular access to their homes are classed as directly affected; all others who have an alternative vehicular route are classed as indirectly affected and cannot be exempt. To meet the objectives of the school street, it is necessary to minimise volume of traffic and it would not be possible to provide an exemption to anyone who has an alternative route. By facilitating non-essential traffic, it will do nothing to encourage a change in behavior. Notwithstanding, in light of issues that have been raised by some residents, the Council has been reviewing exemptions; for example, there are already provisions within the system for residents to enter the vehicle registrations of taxis that are being used to transport them for medical reasons. There are also provisions for carers.
- The purpose of the school street is to improve safety, reduce risk and improve air quality in the restricted road as well as reduce traffic in general; after all, if parents or other visitors are discouraged to drive during the peak periods, there will be reduced traffic on route to and from the restricted roads. Another objective is to improve road safety and perception of road

safety not only for pupils attending the school, but also for the residents and their visitors. This can be achieved by minimising volume of traffic past the school and remove the associated parking whilst pupils are arriving or leaving. For a school street to remain effective and to meet its objectives, it is necessary to reduce volume of traffic by reducing number of exemptions. Many delivery services can be made aware of the restricted periods when placing an order and deliveries can be made outside these hours. Trade personnel and other visitors can also enter the road either before or after the restricted periods. Emergencies can be exempt after the event as long as evidence of emergency is provided. Every effort is made to minimise inconvenience but it simply is not possible to accommodate every scenario or eventuality.

- The school street restrictions do not prevent residents from accessing their homes, and the system makes provision for exemptions under certain circumstances. In terms of visitors, there is nothing preventing visitors arriving within the restricted periods as long as it is not in a motorised vehicle. The Council has a number of initiatives that encourages those travelling within the borough to use active and / or sustainable modes of transport and not be so reliant on the use of private motorised vehicles.
- There appears to be a misunderstanding amongst some residents regarding the exemption process and the contravention itself in that during the restrictions, drivers who are not exempt cannot enter but can leave at any time. If the scheme becomes permanent, a newsletter detailing these points will be sent to all the residents.

4.9 All statutory bodies have been consulted and no objections have been raised.

4.10 The local Ward Councillors have been engaged during the consultation process. The results of the consultation and officer's recommendations were presented to the Ward Councillors prior to preparing this report. Below sets out the comments received from one of the Ward Councillors:-

There should have been earlier consultation with residents to identify issues in advance. For those who are disabled and rely on a taxis service to and from their properties a list of approved taxi services beforehand would have helped.

Lack of enforcement has encouraged some continued parking on the designated school streets.

Officer's comments

Please see above paragraphs in section 4.8 of this report.

5. OFFICER'S RECOMMENDATION

5.1 When considering the outcome of the statutory consultation, consideration must be given to the nature and validity of the comments / representations and the Council's objectives. A statutory consultation invites objections to the scheme and since only 24.8% of those directly affected have chosen to object (some of which are based on a misunderstanding of the exemption process), it could be viewed that 75.2% of those directly affected do not object to the scheme.

5.2 It is considered that the benefits outweigh some of the inconveniences some residents / motorists may experience. School streets are in line with other policies and initiatives across the Borough and London, and believed to be the right step toward changing behavior as well as achieving the various benefits. Benefits include improved safety / perception of safety; the removal of the school-associated obstructive parking; reduced risk to all road users; reduced pollution, including noise pollution; improved air quality in the restricted road as well as reduced traffic in general; after all if parents or other visitors are discouraged to drive during the peak periods, there will be reduced traffic on route to and from the restricted roads.

5.3 It is recommended that the permanent Order is made to retain the school street.

- 5.4 To reflect the change in the school's hours, it is recommended that a statutory consultation is undertaken to change (reduce) the existing restricted hours to 8.15– 9.00am and 2.45 – 3.45pm.

6. ALTERNATIVE OPTIONS

- 6.1 To remove the restrictions. This would compromise if not totally undo all the benefits that have been gained thus far and it would do nothing to encourage a change in behaviour. It would be contrary to the various objectives the Council is trying to achieve.

7. TIMETABLE

- 7.1 A newsletter detailing the results of the consultation and Cabinet Member decision will be distributed to all consultees soon after a Cabinet Member decision is made and published. The permanent Traffic Management Order will be made and published soon after.
- 7.2 The statutory consultation to reduce the restricted hours will be undertaken soon after Cabinet Member decision is made and residents will be informed accordingly.

8. FINANCIAL RESOURCE AND PROPERTY IMPLICATIONS

- 8.1 All the associated costs are covered by the LSP funding provided by DfT / TfL.

9. LEGAL AND STATUTORY IMPLICATIONS

- 9.1 The Traffic Management Orders would be made under Section 6 of the Road Traffic Regulation Act 1984 (as amended). The Council is required by the Local Authorities Traffic Order (Procedure) (England and Wales) Regulations 1996 to give notice of its intention to make a Traffic Order (by publishing a draft traffic order). These regulations also require the Council to consider any representations received as a result of publishing the experimental order.
- 9.2 The Council has discretion as to whether or not to hold a public inquiry before deciding whether or not to make a traffic management order or to modify the published ETMO. A public inquiry should be held where it would provide further information, which would assist the Council in reaching a decision.
- 9.3 The Council's powers to make Traffic Management Orders arise mainly under sections 6, 45, 46, 122 and 124 and schedules 1 and 9 of the RTRA 1984.

10. HUMAN RIGHTS & EQUALITIES AND COMMUNITY COHENSION IMPLICATIONS

- 10.1 The Council carries out careful consultation to ensure that all road users are given a fair opportunity to air their views and express their needs. The design of the scheme includes special consideration for the needs of people with blue badges, local residents, school children and businesses without prejudice toward charitable and religious facilities.
- 10.2 Bodies representing motorists, including commuters are included in the statutory consultation required for draft traffic management and similar orders published in the local paper and London Gazette.
- 10.3 The retention of the restrictions / improvements affects all sections of the community especially the young and assists in ensuring improved road environment and air quality for all road users and achieves the transport planning policies of the government, the Mayor for London and the Borough.

11. CRIME AND DISORDER IMPLICATIONS

11.1 None

12. RISK MANAGEMENT IMPLICATIONS

- 12.1 There may be some dissatisfaction amongst the objectors but the benefits of the scheme outweigh majority of the comments made against the scheme.
- 12.2 The risk of not retaining the improvements / restrictions would be a step backward in terms of Council's objectives and will not be in line with the Council's various strategies and projects.

13. ENVIRONMENTAL IMPLICATIONS

- 13.1 When determining the type of schemes to be designated on the highway, section 45(3) requires the Council to consider both the interests of traffic and those of the owners and occupiers of adjoining properties. In particular, the Council must have regard to: (a) the need for maintaining improved movement of traffic, (b) the need for maintaining reasonable access to premises, and (c) the need to reduce road collisions.
- 13.2 The restrictions removes traffic from this section of the road that makes it safer and more environmental friendly for residents and visitors.

14. Public Health Implications

- 14.1 School Streets and Low Traffic Neighbourhoods (LTNs) have important implications for public health in terms of physical activity, air quality and safety by creating healthy and secure neighbourhoods.
- 14.2 The implementation of School Streets and LTNs encourage the use of active travel options such as walking and cycling and build physical activity into daily routines. The removal or reduction of traffic from certain roads may encourage residents (particularly children) who would not usually consider active travel options to take these up in a quieter and safer environment ([Aldred, R. and Verlinghieri, E. 2020](#)).
- 14.3 Traffic is a key contributor to poor air quality in the borough which can have important health implications. The reduction of traffic in primarily residential areas or streets with schools can improve air quality in local areas and reduce the risk of developing cardiovascular disease and other health conditions. Studies from Waltham Forest found that in particular, there was a reduction in the amount of pollution caused during the school run where these schemes were in place ([Dajnak, 2018](#))
- 14.4 Implementation of these schemes have an important role to play in improving our local areas in terms of road safety. Reducing the flow of traffic in residential areas or in areas close to schools can reduce the risk of residents being involved in a serious collision with a vehicle.

15. APPENDICES

15.1 The following documents are to be published with this report and form part of the report.

- Appendix 1 - Newsletter & Plan
Appendix 2 - Representations to statutory consultation

SCHOOL STREETS
 Restricted Vehicular access
 Aragon School



ISSUE DATE : 25 AUGUST 2020

INTRODUCTION

As part of the Council's objective to reduce congestion, pollution, risk of collisions and provide a safe environment within the vicinity of schools, the Council has a rolling road safety and accessibility programme. Measures that are often implemented include 'school keep clear' zig-zag road markings to prevent drivers parking close to the school gates and to improve sightlines; localised 20mph speed zones with accompanying traffic calming measures and road safety education. These measures have been very successful in most areas, as there has been an improvement in perception of safety. Although these measures have been successful in ensuring access and safety, the level of congestion, risk and air quality outside the schools remain a concern. The contributing factor is the high localised volume of vehicular traffic within the vicinity of schools often generated by parents / carers of pupils attending the school.

PROPOSAL

To improve safety, active travel and air quality, and in response to Covid-19 pandemic, the Council intends to restrict motorised access in and out of the identified roads that accommodate school pedestrian gates during the morning school opening and afternoon school closing periods under an Experimental Traffic Management Order (ETMO). During these periods, the road will be predominately 'pedestrian and cycle only' zone. Residents who live in the affected roads will be allowed access as will staff who are based at the school; those with special needs children who need to be driven to school would also be exempt. Those who are exempt must register with the Council; exemptions would be subject to meeting the appropriate criteria.

The appropriate signs will be in place to inform all motorists of the hours of closure.

The restrictions will be enforced by a camera

The surrounding roads will be enforced against obstructive / illegal parking

This measure is introduced to protect children and we would appreciate your assistance and support

It is appreciated that this may cause some inconvenience and where possible the Council will endeavour to accommodate residents; however, for the scheme to be a success, the Council would require the cooperation of the school, parents and residents. We ask that the school and residents support our proposals and rearrange certain activities such as deliveries and receiving visitors outside the identified hours during each school term.

CONSULTATION PROCESS

The proposed measure is being introduced at the start of September term and will operate term times only during the published hours under an Experimental Traffic Management Order.

The Experimental Traffic Management Order will allow the Council to implement the restrictions during the consultation period.

- It allows the Council to assess and monitor the restriction and its impact.
- It will enable the residents and other road users to experience the restrictions thereby allowing them to make informed comments.

www.merton.gov.uk

The restrictions and the Order will be in place for a maximum of 18 months. Anyone can object and make representations within the first six months (the statutory/formal consultation period) of the experimental Order coming into force and the implementation of the works. Consultees (mainly residents) are encouraged to make their comments at least 3 months after implementation. Consultees will have 6 months to respond to the consultation. All representations will be considered prior to making a final decision which could include its removal, making some modifications or making it permanent.

Additional notices will also be erected within the vicinity of the proposals to inform residents and road users of the start of the restrictions and the statutory consultation

All available information including updates will be posted on the website.

<https://www.merton.gov.uk/covid-19-transport-projects>

All representations must be made on line using the above link. Please note that you may not be able to submit any comments until November 2020. A response will not be made until the consultation is concluded and a final decision is made. The Council will monitor the situation and will make the appropriate adjustments if and when necessary.

To APPLY FOR EXEMPTIONS

Exemptions will be given to residents, teachers and special needs children. Residents and teachers MUST register with the Council to qualify for the exemption. Carers visiting residents who live in the road will also be exempt if their registration are logged with the Council. However, we respectfully request that, if possible, visitors arrange their visits outside the restricted hours.

The quickest and easiest way to apply for School

Street exemption is to use our self-service website which we are in the process of setting up. Please check the website for updates.

ENFORCEMENT

During the restrictions, enforcement will be carried out using cameras. However, please note that full enforcement will not be carried out until residents are given the opportunity to apply for exemptions.

We do apologise for the short notification and the fact that the exemption process will not be available immediately but we believe that starting the process will have some benefits.

LOWER MORDEN WARD COUNCILLORS

Cllr Stan Anderson
Phone - 020 8545 3424
Email: stan.anderson@merton.gov.uk

Cllr Mary Curtin
Phone - 020 8545 3424
Email: mary.curtin@merton.gov.uk

Cllr Sally Kenny
Phone - 0208 545 4026
Email: sally.kenny@merton.gov.uk

Cabinet Member for Regeneration, Housing and Transport.

Cllr Martin Whelton
Phone: 020 8545 3425
Email: martin.whelton@merton.gov.uk

www.merton.gov.uk

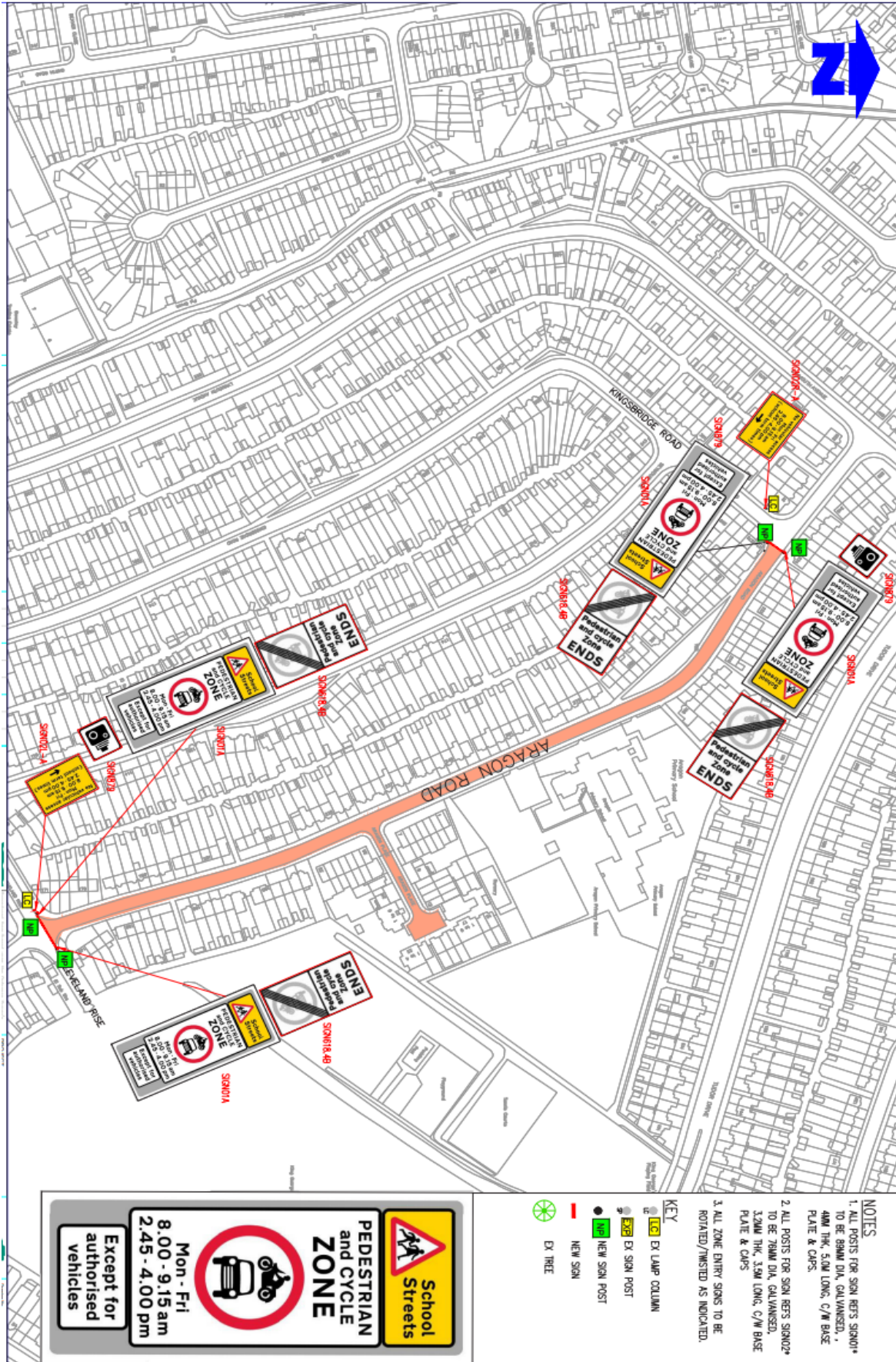

Road name	Views	Comments
REPRESENTATIONS FROM WITHIN THE NEWSLETTER POSTAL AREA		
Aragon Road 6345749, 6261479, 6298630, 6331196	AGREE	<p>I have lived here for 46 years and this is the best thing for the safety of the children. As I live opposite the school over the years I have seen a few near misses regarding children trying to cross the road to school between badly parked cars. It's healthier too for children to do a bit more walking. We can also get on and off our drives as they are not being blocked at school times anymore. All in all I think it is a great scheme for everyone.</p> <p>-----</p> <p>This is the best idea for the safety of children outside school. As I live close to the school, over the years I have seen a few near misses involving children crossing the road and cars speeding along. The residents campaigned a long time ago to get humps put in to slow traffic down but it was rejected. Also no exhaust fumes with engines running and residents able to drive on and off their drives as they are no longer blocked by parents parking across them although we have double yellow lines there. For all concerned let's hope this scheme is permanent.</p> <p>-----</p> <p>It's made a huge difference to all concerned in a good way. No pollution, less traffic, safer for children. Exercise for children as they need to walk more.</p> <p>-----</p> <p>The best scheme 100percent. Safe for the children, no engines idling outside school and homes. No cars parking on double yellow lines outside houses blocking drives. Also healthier for children to walk a little.</p>
Aragon Road 6346427	AGREE	<p>The advantages of the scheme far outweigh the disadvantages. Until this scheme was introduced at school run times the traffic down the school end of Aragon Road where I live was actually gridlocked, a very unhealthy environment for children and an absolute inconvenience for residents who continually had vehicles parked outside their driveways - this is not so bad if the driver remained in the car but more often than not they had actually left the vehicle to accompany their child or children to school. Having dropped their child off to school the drivers would often then congregate to have a chat with other people but still leaving their vehicles illegally parked over the driveways of residents. My mother in law who is 98 and lives on her own at the other end of Aragon requires our frequent attention and the illegal and constant parking over our drive has often been a huge and worrying inconvenience. As for the problem the scheme causes for tradesmen and delivery drivers, whilst the scheme has been in operation I have had the need for several tradesmen to visit my home but when told that they cannot drive down Aragon Road to my house until after 9.15 am in the morning this has not presented them with a problem at all. The environmental advantages of the scheme far outweigh any perceived disadvantages for tradesmen. Whilst the scheme has been operating I have not had the need to take photos of cars illegally parked outside my home nor contact a CEO to ensure enforcement. .</p>
Aragon Road 6339717	AGREE	<p>In principle the scheme comes across as beneficial but the implementation process has been poor. Initial information literature never received in the post by me and some of my neighbours within the zone resulting in problems registering vehicles. Took a while to sort out and the reason given being we were wrongly excluded from the list of residents. Quite stressful trying to contact and get an exemption for trade vehicles - I had to get an exemption. There was a lot of hanging on the phone/sending emails. Would suggest an online option to make this process more straightforward and user friendly or a direct line where a vehicle exemption can be made and that can be easily found on your website. I would suggest that online shopping deliveries should also be exempt as it is not generally possible to book precise delivery times.</p>
Aragon Road 6331089	AGREE	<p>My husband is a disabled person who requires daily carers and family assistance. However, we have had to change the times the carers visit to after 9.15am and family members who do not live in the area to access at alternative times which causes all</p>

		sorts of issues with hospital appointments etc. Whilst we agree with the experimental traffic management scheme, we do feel that some consideration should be given to preventing Care providers, visitors and tradespeople from accessing the street during these times.
Aragon Road 6246631	AGREE	Don't think you have introduced the scheme correctly to the residents, the first we hear of this is a leaflet thru the door telling us no one can drive between certain times or have deliveries. Obviously we would all do our best not to have deliveries at these times but we can't dictate traffic for delivery drivers and if my elderly parents come to collect my son from Aragon School they will need to park on my drive (so they don't have to walk too far my father has a walking stick) and arrive during the times you have stipulated. I also think you should have been issuing us with the permits before talking about us not driving in the road with live in.
Aragon Road 6334822	AGREE	One of the residents of Aragon Road has kindly informed me that I can have my say about the road restrictions imposed on Aragon. As a resident and a Grandmother who's grandchildren attend Aragon School I am very much in favour of these restrictions, in fact I emailed Siobhain Mcdonagh a few times to let her know my concerns about the users of this road and that it would be a matter of time before a fatal accident would happen. In my opinion the parents that drive their children to school mostly are responsible parents but as in life you will always get the minority that are not responsible and its those parents that need to be penalised for their dangerous actions. Recently I have noticed that two drivers seem to be flouting the rules with no regard for the safety of children and the law that is trying to keep them safe. I have their registration numbers and would ask:- 1. If the cameras are actually working why have these parents not been stopped as they are clearly breaking the law daily. 2. If they are exempt from this law, why ? 3. Our children have to adhere to the time restrictions so why are these two cars allowed to travel within these times. 4. Many times I have witnessed them reversing onto peoples driveways with no regard for the children's safety. Car registration numbers : X & X I'm sure that many residents have family members that wish to visit but are restricted to the times and these members abide by the rules so there should be no allowances. These restrictions should remain in place because the safety of the children is paramount. The residents of Aragon Road should have some help in this matter as there are a number of elderly people living here and there children should be able to visit any time with no restrictions.
Aragon Road 6338400	AGREE	Must be enforced - parents are still ignoring signs
Aragon Road 6330797	AGREE	Parents Parking over drives as become an big issue also the safety of children and Pollution I agree with the restrictions after all its 1/14 hours morning and again afternoon
Aragon Road 6298598	AGREE	As a resident I have found that the scheme is of great value to the community. The parents can cross the road freely without having to squeeze between parked Cars and fear for their lives. There is less pollution and The children seem happier Going in and coming out also the noise level is greatly reduced. I hope that the scheme is going to be carried on .
Aragon Road 6248907, 6261466, 6298579, 6298600, 6331195, 6345748	AGREE	I feel that the signs for motorists should be larger or a cctv sign under the existing notices to attract drivers notice. ----- Vast improvement for child safety and making life better for residents. Well done to the council for finally finding a solution. ----- Much safer for children, less pollution, better for residents. Will only improve once it is enforced more. ----- Great scheme for child safety and residents. Ticks all the boxes. Permanent anpr cameras would make scheme even better. ----- Much safer for children and definitely better for the environment. Best council scheme ever.

Aragon Road 6249648	AGREE	As these restrictions are now in place - please REMOVE the double yellow lines that were installed opposite Aragon School. There is no requirement for them to be there as school traffic is not permitted in the area. These double yellow lines have been ignored by parents, and have not been enforced by the council. They impact on the residents at all times of day and all days of the week so are not proportionate and unfair on the residents of the properties covered. Hasty implementation of scheme with no apparent consideration of residents needs and deliveries etc. Exemption process should have been in place before the school restarted.
Aragon Road 6346619	AGREE	Our house is directly opposite one of the school car park entrances on Aragon Road. Before the trial scheme we saw how dangerous the road was at these times. Aragon Road is narrow, on a bend and single track due to parked cars. Combined with high volume traffic this created a dangerous and heavily congested bottleneck. Mixed in were parents and children trying to cross the road to get to and from the school. We have also had to contend with parents illegally parking their car over our drive, blocking our cars in, and leaving it unattended to drop off their kids for often up to 20 minutes. So we are massively in favor of this scheme, it must be made permanent. It needs to be enforced because many of the parents ignore the restrictions now knowing there is no risk. Provision must be made for residents to easily apply for temporary exemptions for trades, visitors etc..
Aragon Road 6347631	AGREE	the road has been much safer with out the parents parking and blocking the road some times arriving very early and sitting in the cars waiting ,some with the motors left running while standing talking with other mums while the children run around the air also much cleaner now their not doing this I can see clearly down the road and watch for anyone who might run in the road. my wife and I are both over 70 and we now have a much better chance of parking near my house.
Aragon Road 6248680	AGREE	I live at the other end of Aragon Road to the school, am I allowed to drive up from the bottom end past the school during the restricted times for access to my house?
Aragon Road 6330746, 6330741	AGREE	Pollution for the children Safety crossing the road Mothers fathers blocking access drop downs putting there children safety at risk getting hit by a car Inconsiderate blocking neighbours in It's like Piccadilly Circus Mums dads fighting in the roads won't move there cars Swearing at neighbours Who cannot get to hospital appointments We also have children need to get them to other schools can't get of our drives Leave their cars running across your drive and take kids to school hazard lights on causing pollution. ----- Safety for children Fumes protecting children Parking blocking emergency exists of peoples drives Ambiance fire engines police can't get down the road Mothers fathers fighting won't move there cars Children watching abusive mums dads won't move their cars jaming the road. Kids cannot see the road as drop downs blocked by school mums dads
Aragon Place 6330742	AGREE	Motor bikes doing one wheels speeding cars as well While road blocked by a swarm mums dads Drop downs kids can't see the road They need a crossing across the road near the school Rude mums dads shouting at each other won't move cars Blocking neighbours access Arguing with the neighbours Police and wardens being here moving them on Mums dads arguing with each other Danger pollution at these times too many cars affecting children's breathing
Aragon Place 6330749	AGREE	Safety first for children pollution free for children Speeding free for children Safety kids can see the pavement cars not blocking them These mums dads blocking roads Endangered their own children's safety Rudeness parents shouting at neighbours Leave flashing lights on blocking drives Pollution
Aragon Place 6330744	AGREE	Congestion pollution for the children. Screaming fighting mums dads Mums dads would leave there cars running across our drive And take Children to school fumes danger Children can't see the roads Yes the close the road safety for Aragon school children
Aragon Place 6331375	AGREE	I am of the opinion that although I agree with the scheme I strongly feel that additional exemption must be granted for an additional family member in order that access be granted for support to be given. For example my daughter has to drop my grandchild to me on her way to work sometimes in order for me to provide child care before I take her to school in Worcester Park. This has to be during the exempted hours. I believe

		this aspect of the scheme has not been taken into consideration. Residents should be able to supply additional registration plates for essential visits for child care and other essential visits. Aragon Road is a long road and there are elderly residents. I do hope the original decision not to grant additional exemptions can be overturned. I was unaware until Ms x knocked last night to show me her email correspondence that residents were being allowed to give their feedback. No letter has been received by me. I await hearing the outcome
Aragon Road 6332815	DISAGREE	Aragon Road is not a generally busy road, except at school times. The hazard to children are from their parents/careers who drop them off in the morning and collect them later. The scheme moves the problem to adjacent areas, the problem is still there, but in a different location and possibly more dangerous as the drivers park in inappropriate places. The children have to cross more roads to get to school, crossing in the path of vehicles avoiding the no go area! It also creates tension between drivers and residents, when crossovers are blocked. The no go area creates a huge amount of problems to people living within it, from deliveries, people being collected to go to hospital or other appointments or just the normal coming and goings of a normal life. These schemes are not being implemented on busy roads, where there are greater risks from cars and pollution for the children, because it would it would snarl the transport system up.
Aragon Road 6346695	DISAGREE	First I would like to ask what data was used to determine why this scheme was necessary in Aragon road. Was a risk assessment conducted? I feel it has done nothing to improve the safety of the children attending school. I have lived across the road from the school for 20 years and have never heard of any issues. If you believe that you've solved a safety issue all you've done is to move the problem further up the road. The problems experienced by residents in the zone is unacceptable. Visitors cannot visit, deliveries cannot be arranged around these hours. As a grandparent who cares for my grandson it prevents him being drop off at my house. I'm also aware of other residents not being able to get a taxi when required to take them to hospital appointments and not being able to walk outside the zone because of health reasons. I believe a longer review time is needed to determine if there is a real benefit to the safety of the children.
Aragon Road 6329283	DISAGREE	The restrictions placed on residents of these streets are unfair and have a direct impact on our ability to run businesses and have a family life. This extends to movement of ourselves in vehicles and receiving goods and services: 1. Time availability for services such as BT and British Gas are affected if they cannot come and go freely according to their schedule. 2. My office is at home but you are stopping me from returning to my home at certain times of the day and I visit clients at times to suit them. 3. My son is autistic and currently does not have a school place. We have tutoring in place and I take him out of the home for educational visits. By restricting the times when I return home, you are affecting my ability to parent and provide the support he needs. Also, with an autistic child, sometimes your schedule has to change and you need to return home when required for the child. 4. When my work requires me to travel, by restricting a taxi coming into the road within certain times, you are causing potential risk to myself and others. If I am required by Covid regulations to self-isolate after travel, then the taxi needs to bring me directly to my house and not have me walking along the road.
Aragon Road 6330612	DISAGREE	I am concerned as Aragon road is already being used as a cut through and all this will do is direct the traffic to the other end of Aragon where the school Children walk from already not solving the issue and just creating the issue on the other end of Aragon.
Aragon Road 6331055	DISAGREE	It doesn't help as cars now park on cleveland rise and make the other side roads busy. It would be better to have no stopping signs with cameras outside the school.
Aragon Road 6330924	DISAGREE	I don't understand why the street is restricted as it is not a busy road anyway. Already there are too many cars trying to park just outside of the restricted part of the road making it dangerous and extremely busy for other road users. This area is also the entrance to the playing fields making it dangerous for park users due to all the cars parking and moving around, waiting for spaces to park! I was also not notified of the new restrictions which will probably result in myself receiving a fine. How can I access my driveway during these hours? Will I be exempt? Will visitors to my house during these hours also be exempt? I believe I should have, at the least, been notified of the

		planned restrictions before they were put into place, why have I not received any correspondence from the council?
Aragon Road 6330069	DISAGREE	---
Aragon Road 6330827	DISAGREE	---
Aragon Road 6330498	DISAGREE	1, We have NOT BEEN consulted and we have received NO information AT ALL and neither have some of my neighbours concerning this scheme.....we don't even KNOW WHERE OR HOW to register our vehicles?????!!!! 2, We are totally AGAINST this scheme in Aragon Road. 3, All this will do is create a parking/traffic problem at the junctions of Aragon Rd with Cleveland Rise/Kingsbridge Road and Lynmouth Avenue effectively pushing the minor problem twice a day from Aragon Road to the surrounding area. 4, This scheme will not allow any contractors, deliveries, family etc to visit our premises between the active hours and that infringes on my human rights and freedom and we OPPOSE this scheme in its entirety! 5, There has been ZERO consultation from Merton Council, as per usual, just imposition AGAIN! It is disgraceful that, once AGAIN, you implement a scheme in the borough without the proper consultation with residents! 6, It is only because one of my neighbours has taken it upon herself to find out information that YOU should have provided to EVERY house on MORE THAN ONE OCCASION, that we have found where to complain to. 6, We want you to remove this ridiculous scheme immediately, then maybe ASK the residents what they suggest. 7, If you are concerned about the safety of the school children and traffic, then maybe you should place SPEED HUMPS outside the school at Aragon Road, or indeed along the that would slow the traffic down. the children are ALL of primary school age and WILL ALWAYS have their parents with them so traffic accidents are very rare. 8, Please remove this scheme asap, we DO NOT want it!
Aragon Road 6331172	DISAGREE	This is putting too much emphasis on residents rather than children's parents. The responsibility and safety of their children should be theirs rather than the residents. It will cause problems for delivery vans, medical visits, builders, workmen, etc. For the road to be basically shut for 3 hours a day is totally unreasonable. The suggestion that visitors should park outside the area is ludicrous; not the least because school parents will be parking there. Also, we are in our seventies and not really computer literate so downloading various documents will not be possible.
Aragon Road 6330481	DISAGREE	We've lived in Aragon Road for 18 years and have endured many challenges of having a primary school in this Road but why should we be inconvenienced further - we should not be prevented from having our homes and lives from normal activity such as family visitors deliveries and tradespeople at times to suit us - we pay council tax Road tax and this is now a step too far - I want my family to feel able to visit at any time day or night and with my young grandchildren being dropped to me for childminding so my daughter can work this is beyond unfair!
Aragon Road 6330768	DISAGREE	This will negatively impact all deliveries coming to residents as well as resident's visitors.
Aragon Road 6329918	DISAGREE	Good morning I am a resident of Aragon road and my daughter attend Aragon Primary, I think it is great to try keep the area safe however I DO NOT think closing off the street is a good idea. It leaves residents with no access to their homes for delivery or emergency situations. I work for a maintenance firm and we often attend during a time slot in the day, either morning or afternoon which is both in times the road is not accessible. Should I require a tradesman during this time they won't have access to my property and I would be charged the fee for their attendance due to no access. To expect them to park at the top of the road is simply unrealistic, no tradesman is going to walk with his tools all the way down to my property especially not in the great British weather. I will then have to pay for his time parking walking to and from his van to get his tools as his time is chargeable and he is here to provide a service for me which is being made difficult by the council. The only person who will be out of pocket will be the resident and the potential damage in their property due to lack of service by non attendance or access issues. Would it not be better to just block of the part that is directly in front of the school, by no means am I saying it is ok for those residents to be

		inconvenienced but it would certainly make the unaccusable area smaller. What if it starts at Aragon place, people can then still drive and turn around to have access to the property and the same on Lynmouth? At work I sometimes drive different vehicles from our fleet - how do you propose I register any of the 90 vehicles I might drive on different occasions? I chose to live on this road because of the school, my tight working schedule do not allow for me to park miles away and make it to collection on time, this is the whole reason why we bought a house on this street to avoid these problems...!
Aragon Road 6347806	DISAGREE	Since your letter in May with regard to the School Streets scheme, I have observed it's effectiveness in Aragon Road. During these hours Aragon Road is not a 'predominately pedestrian and cycle only road' , as there are over 160 private resident houses within this zone (many with more than one vehicle), together with teachers & exempt parents, resulting in many vehicles needing to use this road at all times. This appears to have resulted in children being more at risk, as they are now often travelling alone or with their friends, as parents drop them on the perimeter of the zone, and they are often too young to be aware of the dangers of the many driveways/roads they need to cross with moving vehicles. It also seems that many parents enter the zone prior to the restriction time, wait in their vehicles often with engines idling, and are then free to leave the zone with no penalty. As far as I can see as both a teacher and a resident, while making less volume of traffic driving down Aragon Road, this scheme has not improved local congestion, pollution or collisions, and has not made for a safer environment for children either, and just resulted in the surrounding zone area being more congested and dangerous for all.
Aragon Road 6331068, 6329858	DISAGREE	Having been a resident in Aragon Road for the past 32 years, and endured the many challenges of having a primary school in this road, I am in full support for a scheme to monitor and safeguard the children and adults that need to attend this school and that where possible parents and commuters should be deterred from using school streets. However it seems wrong to prevent some 160 private households in this long stretch of Aragon Road and Aragon Place to have visitors, deliveries and tradespeople unable to drive to their home for some 3 hours every day, 5 days a week in term times. Currently, since the introduction of the school streets scheme last September, all that has happened is that the school parents drive and block the roads and driveways on the perimeter of the restricted zone, causing a further problem to residents of congestion and pollution, while Aragon road is still not car free (registered residents still able to drive past the school) resulting in children not being so street wise/observant as they think the road is closed and forget to stay alert or aware of their surroundings, putting them more in danger. Also having spoken with some of my elderly and vulnerable neighbours, who rely on support from family members, they are very concerned at the restriction of visitors being able to come to their homes to help them. Would it not be more appropriate to restrict the through traffic in Aragon road during these hours, but still allow private residents in the affected area to apply for additional vehicle exemptions for visitors/family members whose vehicles are not registered at their home address to still have access?
Aragon Road 6348020	DISAGREE	The scheme prohibits vital service people from entering the street, Aragon road in the mornings and afternoons. We are given different times they can deliver or attend an emergency. Trades people will pass on the cost of the ticket to us as part of their bill, because they are given a ticket when they come to our home to do work. It's ok that we plan meticulously, however, all best plans are never full filled and adjustment has to be made. I understand why the scheme was introduced, but pushed through without a full and proper consultation. I initially object, but it still went ahead. If parents parking at our gates/drives is an issue, then work with the school, and enforce it with your mobile operatives who can differentiate between a trades person from a parent, dropping off their kids, who can walk. You can also close the Aragon entrance and the parents enter from the Tudor drive entrance to Aragon Primary School. My elderly neighbours need various visitors , health care during the day, including morning and afternoon, and they are also having issues. penalise the parents who congest the street, but do not penalise the neighbours and the vital service they need to service, fix their homes. The new measures have caused issues on adjacent streets and has also had the desired effect of making some parents walk, but all they do at times is drop their young people off early at breakfast clubs, I assume. The school children will

		become complacent and their road safety vigilance may diminish if they are not careful. The issues that cause these measures to be introduced have only shifted to an earlier time. Another method to deter the parents need to be found that suits both school, parents and most importantly the residents need to be reached with proper consultation. Thanks
Aragon Road 6346916	DISAGREE	Whilst I appreciate with you are trying to achieve with pending restrictions in Aragon Rd I must point out that the changes the council are proposing will have a dire consequences for me and my husband. My husband has been diagnosed with chronic depression and mental health issues which includes major anxieties and is under the mental health team at the Wilson and attends appointments at St Helier and Epsom. He has major mobility problems due to vascular and knee problems and unable to walk very far unaided. The recent lockdown has exasperated both his mental and physical health. Almost all his hospital appointments are in the morning and during the proposed restrictions. I need to be able to order taxi that can pick up on my drive way. Your proposals will not make this possible. I am in my 70s and not in the best of health and am also the carer for my 93 year old father and again will need to be able to call a Taxi any time if I need to get to him quickly! Just recently we had to wait in the surgery and wait till 4pm when we could call a Taxi to take us home. This had huge complications and increased my husband anxiety and panic attacks. Please can I have a dispensation so I am able to call a taxi to get my husband to his appointments on time and make our lives bearable we look forward to hearing from you
Aragon Road 6330772	DISAGREE	I've had problems with food deliveries due to these proposed restrictions- therefore simply not something I support- the ability to receive essential provisions cannot be impacted.
Aragon Road 6343382	DISAGREE	This has just pushed the problem further up the road and now made the park entrance unsafe as cars block the entrance. On Tudor drive cars block the park parking which causes a tailback. It would be better to close the school entrance on Aragon and make the entrance on Tudor drive the main entrance to stop the traffic. The residents cannot have people visit at certain times in the day it creates problems with deliveries and any workmen that we book. Whoever came up with this idea thinking it would control the traffic - it has just created a problem further down the road
Aragon Road 6331139	DISAGREE	My son lives at home and is a personal trainer, so regularly travels to clients during the day, during school hours, this will affect his business. I regularly receive deliveries, this will also affect them. What about workmen who we employ to carry out works on our property, I also work and have to leave during school time, and come home during school kicking out time. How will this affect my need to go to work. It is my right as a road tax payer to be able to come and go from my property as I see fit. My oldest son has a serious eye condition, he has to be taken to hospital appointments some during school time, I am not always able to pick and choose appointments, I have to take them for him when they are offered. So the closing of a road because of a school is ridiculous, perhaps the council needs to look at the way parents drive like maniacs down Aragon Road, because they are late getting said child to school, or where a parent parks their car, regardless of whether or not they are blocking a residents driveway, or even more selfish parents who ride pushbikes and electric scooters on the pavement at speed, with school children, making the pavement a very dangerous place for pedestrians.
Aragon Road 6330565, 6346449	DISAGREE	I can't have visitors during the restrictions times however school parents can drive and park up prior to the restricted time and drop off or pick their child up doesn't this defeat the purpose of the scheme. ----- Just moving the congestion to the surrounding streets.
Aragon Road 6336907	DISAGREE	In a time where we are spending most of our time working from home, it would be nice to have the freedom to access our houses at any time of the day. We have had comments from our grocery delivery drivers telling us that we should not book grocery slots during those times as they are not allowed to enter. This was difficult to arrange when delivery slots were already sparse. It is also not clear when 'term time' dates are, especially when kids have been asked to study at home for much of the year. These term time dates would only be common knowledge to those with kids who attend the school. It also appears as though kids are leaving and entering the school in staggered ways due to COVID, therefore the parking restriction timings seem arbitrary

		in relation to these staggered movements of the children from the school. On a personal note, the car I am insured on is my dad's car, which is registered at a different Morden address, and so I cannot register it to my current address.
Aragon Road 6346924	DISAGREE	1. I have deliveries coming to me most days. Only am or pm times are given for deliveries not specific times. 2.my wife will be coming out of hospital soon and will have various people caring for her, how does that work? 3. Why can't access be via tudor drive for the school. 4.parents are disrupting access by parking on road corners and over driveways. 5.my daughter is a key worker and parks on my drive to go to work, yet she will not be allowed a permit. How is that fair. please desist in this trial
Aragon Road 6330614	DISAGREE	I cannot have visitors at certain times of the day. I don't want my friends & family to have to worry about what time it is! Delivery drivers can't deliver. It just brings more congestion to other roads nearby.
Aragon Road 6329058	DISAGREE	The way it has been implemented means residents can't return to their homes during the allotted times is moronic at best. I agree with the principle of restricting traffic as we were often blocked in but it only pushes the problem up the road and to penalise residents and limit our movement is wrong.
Aragon Road 6346895	DISAGREE	My main home is not in London. I work for a London local authority & need to be in London much of the year so I need a London home base. I have lived on Aragon Road since Oct 2018 & I need to park my car on the street and have freedom of driving movement. 1. My circumstances are not included under registering your car for this scheme. I tried to register my car and explained the paperwork I could provide - Residents contract since Oct 2018; Mail from NHS & my GP and a Bank Account all at my Aragon Road address. None of these were acceptable - told by Ringo that my accom'n contract is too old dated Oct 2018! My car is registered at my main address, told by Merton staff that I should register my car at Aragon Road - I should have the right to choose where I register my car, that it be my choice & what suits me. My work involved visiting vulnerable disabled people, currently I am restricted as to when I can come home between visits & liable to be fined. 2. Deliveries - Receiving deliveries is more difficult. Whether or not you try to be helpful by warning the company not to deliver between certain hours, it doesn't help - Deliveries don't arrive at the time of day you expect them, they don't arrive at all on the expected day and when booking the goods, once the company know about the School Street Scheme the delivery wait time gets extended further into the future. I have also been informed that if the delivery driver gets fined this cost will be passed to the goods purchaser! Any precious time taken off work to accept a delivery is being wasted or we are being delayed in getting back to work because of the unreliability of deliveries. Delivery drivers are causing more pollution by returning to make the delivery. 3. Yellow Lines - If this scheme becomes permanent then you can get rid of the yellow road markings outside Aragon School as they will not be needed for school drop-offs/collections - parking spaces are at a minimum on this road as there are so many drivew.....
Aragon Road 6346915	DISAGREE	I am very unhappy with the restrictions on our road as we were not consulted before the restrictions were implemented. It is a restriction on our civil rights to be unable to drive on a certain part of a public road at certain times of the day, especially the road we live on. The movement of my family is also restricted as they are unable to visit at these times. As a person with severe hearing difficulties and other health issues it is important to have family or friends visit me when I need help. Most of our shopping is now done on-line due to the closure of many high street shops with the knock on effect of covid and delivery is very difficult at these times. It is also impossible for tradespeople to come to attend to gas and water leaks or to carry out essential household repairs. Caring and helping with our Grandchild to enable his parents to work is totally impossible due to these restrictions. It is a great hassle having to register our cars and re-register yearly or if we buy a new car. The statistics of accidents around schools is very low as people are more vigilant and careful to prevent accidents when children are about. I feel very strongly about this and will NOT support these restrictions and I would like our happy neighbourhood to have its freedom of movement restored. Thank you for listening
Aragon Road 6248766	DISAGREE	Lovely idea in theory but may cause a lot of stress to working parents who need to drop kids and go

Aragon Road 6346327	DISAGREE	I have lived in Aragon Road for 21 years. I have never had any problems with the school traffic & my house is directly opposite the school. I think the inconvenience the traffic restrictions cause are totally unwarranted. I can only have family & friends visit at certain times you have made no provisions for residents to receive visitors. My daughter leaves her son for me to take to Aragon School she has to drop him & be off Aragon Road before 8 which is ridiculous. As for deliveries & trades people we have to advise they can only be here at certain times of the day. If feel the times should be shorter & provision made for family of residents.
Aragon Road 6248280	DISAGREE	
Aragon Road 6347774	DISAGREE	Most of the parents just drive into the zone near the school prior to the start of the restriction time, where they then park and wait in the car and are then able to leave the road with no penalty.
Aragon Road 6246467	DISAGREE	1) I would support the use of tax payer funds towards a method that would DEFINITELY reduce traffic. Such as a green school bus or walking school bus. 2) Parents won't give up their cars, they will just stop around the edges of the "school street". 3) It will cause more traffic at the top of Aragon, as it can fit fewer cars and then will cause parents to u-turn. 4) I sympathise with parents who have multiple drop-offs, uncompromising work schedules or who work nights, and so walking would be extremely difficult for them. 5) I would imagine parents who can walk do, as opposed to battling through traffic and stressing about parking. 6) As a council tax payer, and a homeowner, I am strongly opposed to my civil liberties being imposed on by being told when I can receive guests or accept deliveries. Especially as when I bought my home there were no caveats. 7) Regarding point 6), companies may start either refusing to deliver to me or adding a surcharge. The same with if I need any construction work, window cleaning etc. 8) I am against restrictions on road tax paying drivers. 9) I think that schools need to initiate their own initiatives to reduce school traffic, by consulting with parents, understanding their limitations in foregoing cars. 10) I think it's outrageous that this scheme is being implemented without prior consultation, and that consultation commenced after it is implemented. 11) I think this will shift pollution and everyone should be entitled to clean air, not just school kids. 12) The communications have been unclear for residents regarding how to apply for a resident exemption permit, in order to not be fined.
Aragon Road 6246766, 6346660	DISAGREE	It's just a waste of council money and resources it's not going to make any difference to the environment as it only one road. To be honest it just an inconvenience to all Aragon residence with regard to delivery's and visitors . And having to register cars and work vans and with deliveries you can not always indicate a timed delivery . I am sorry but it's just in my opinion a waste of money which could be well spent elsewhere. ----- This is very unfair my son drops our grandchildren off to us and because he dose not live with us he can not come to us we have to meet him in kingsbridge road. We can not have deliveries but can always tell the delivery a time. It defeats the object of this as the parents just park before the Zone starts which causes havoc in the morning, Merton council should of given us the opportunity to give our opinions before they started work. It's just a waist of taxpayers money. In my pinion the whole idea should be scrapped. I feel we have been penalised because I live in nearest school.
Aragon Road 6330557	DISAGREE	---
Aragon Road 6338114	DISAGREE	I live in argon road how can I go out and come back during this restricted time period. This scheme made more traffic in our neighborhoods and not suitable to this street. The decision makers ever thought vulnerable people who lives in this street? During this restricted time periods how can they get help from family or friends? I knew some vulnerable people couldn't go to the hospital appointments due to this scheme in place. It is clearly breach of basic human rights of people who lives in this street. Also this scheme not going to reduce traffic in stead of traffic congestion. I am not clear why council trying to implement this scheme during this pandemic?
Aragon Place	DISAGREE	Hi, my name is Carlos and I live next to the school so I think that if i want to receive a delivery on those times that's mean that I can't or it will be charged. That's just not fair

6346368		for the neighbours, please do not close the road. Many thanks !
Aragon Place 6346917	DISAGREE	no access to emergency cabs, rental cars, friends just inconvenient
Aragon Place 6348043	DISAGREE	---
Aragon Place 6346923	DISAGREE	---

OTHER REPRESENTATIONS FROM OUTSIDE THE NEWSLETTER POSTAL AREA

Tolverne Road 6347936	AGREE	This response is on behalf of Merton Residents Transport Group (MRTG). We strongly support the school street at Aragon School. School streets such as this one play a critical role in reducing road danger to children, improving air quality and enabling walking, cycling and scooting for a wider range of people of different ages doing the school run. They additionally reduce the number of motor vehicle journeys, lower pollution near the school, and reduce congestion. Additionally, we would encourage Merton to take further measures to enhance the visibility and effectiveness of the school street: - Ensure consistent enforcement with the use of permanent cameras; these could pay for themselves and provide funds to further enhance the school street - Install planters at the entrance to the school street to narrow the road width and create a gateway into the school street, enhancing its presence - Provide signage at a lower height, and more clearly delineate the zone - Create new areas of trees and soft landscaping into the carriageway space - these could be parklets, pocket parks or planters to improve the air quality, sustainable drainage to reduce risk of flooding. We look forward to the continued safety and health benefits arising from the school street, and encourage Merton to further expand the scheme to schools not currently covered. Sincerely, MRTG
Kingsbridge Road 6330584	DISAGREE	All the roads in the adjoining areas have so many cars parked on them, although i do not agree with children bring driven to school, i know a lot have to be driven due to parents going straight to work & there is just no where to park and this causes people to park over drives and causing obstruction all around the area
Kingsbridge Road 6330577	DISAGREE	It is hard on people who live in and by the school. I understand we need to keep children safe but my child attends a school on a restricted road and it means that my disabled dad cannot pick him up as he can't walk that far!. Also not everyone lives near to school and are running out of place to park the car. I have three children with disabilities and it is hard enough to get them out never mind do a long walk on top of a Covid pick up at school!.
Lynmouth Avenue 6330778	DISAGREE	This scheme is dangerous and unsafe for pedestrians walking along Lynmouth Avenue near to Aragon Road. My husband walks my two children along Lynmouth Avenue to get to Hatfeild School. He has told me on several occasions that cars will bump up onto the pavement to park towards the Aragon End of Lynmouth Avenue to take their children to Aragon School, with little regard for pedestrians- my children have had to stop on their scooters but as we know sometimes they don't pay attention. The pavement is for pedestrians, not cars. I'm extremely worried for my children's safety on the pavement on the way to school and that is ridiculous! Secondly, it sometimes causes extra congestion on Lynmouth Ave at the junction with Tudor Drive - worse than usual. We need to get to work!!! I don't see the urgency of closing roads near schools. Are the pavements and parental vigilance not enough? I think drivers need to be educated with safe driving, consideration for pedestrians in a school area and respect for the local residents - which means do NOT park across people's drive!!!! It's common courtesy and respect for others.
Lynmouth Avenue 6333290	DISAGREE	I think you should be able to go down these roads at these times, as I take my dogs to the park and need to drive to the park as I have mobility issues .
Lynmouth Avenue	DISAGREE	First thing is that children would be in a habit to use road for walking as no cars are there , which is wrong. It's road and build for car as well . Next road street are packed

6330918		and people are in rush to go to school , taking kids to school should not punished like this. I disagree with this approach which effects residents and parents , council is only collecting money with everyone Else inconvenience.
Lynmouth Avenue 6336167	DISAGREE	The restriction results in congestion in adjacent roads and especially Lynmouth avenue has increase use for access towards other roads
Lynmouth Avenue 6330864	DISAGREE	The implication will impact me and many others living in the surrounding area, parents will park in my already busy street causing congestion and hazards to pedestrians. I would suggest that parents are encouraged to walk their children to school, with the added health benefit. I would suggest that before a child is excepted in to the school a check should be made in to the proximity they live from the school. It appears that residents are paying the cost of selfish parents and poor planning from the school and council. The parents chose to send the children to the school, then it is their responsibility to get them school by foot or public transport.
Lynmouth Avenue 6330866	DISAGREE	There is a free car park in lower Morden lane if there is a need to drive to school this should be utilised. There has been no thought to the impact on local roads around the school and the residents who live close by, making bottlenecks elsewhere. Lynmouth Avenue is very busy in the mornings without pushing further traffic into the road it is unsafe in an emergency. The restrictions you are trying to force on local residents seems poorly thought out. Those who live in the road of the school have to adhere to a number of restrictions which I cannot see being beneficial to the resident. Better and clear road traffic controls in the borough would benefit us all young and old. We have an issue locally of adults on the pavements and in the road on motorised scooters, I have yet to see this address. Clear and consistent speed limits across the borough. Double parking, parking on red routes, etc, address all of these issues to make a difference.
Garth Road 6330643	DISAGREE	Residents ,visitors ,deliveries and tradesmen all restricted crazy scheme roads are for driving on .
Garth Road 6330938	DISAGREE	---
Dudley Drive 6330626	DISAGREE	The scheme has a devastating impact on the nearby streets making them very dangerous. Parents are speeding along the streets looking for spaces, parking without consideration. The zones aren't solving the problem they are just moving them to another area. Please reconsider these plans.
Tudor Drive 6330954	DISAGREE	Appreciate that this scheme was set up for children's safety, however it has just created a problem elsewhere. With the restrictions now in Aragon Road the surrounding area is a lot busier and dangerous, the problem has moved. Children are now much more likely to be run over in adjacent Roads. It has not encouraged children to walk to school, moreover it has resulted in parents double parking, parking over drives, parking over drives and creating mayhem on roads at school times.
Churston Drive 6260489	DISAGREE	Simply not feasible for residents to arrange deliveries etc outside relevant hours, sat navs cannot negotiate so many restrictions, even if timings can be read whilst passing signs at under 20mph trying to turn round will cause chaos, carers etc. still need to access some residents during restricted times, all this does is push traffic to other local roads making them congested. Try carrot rather than stick against end users all the time or put money into viable fuel alternatives as cycles are not a physical option for many or viable for business use etc
Springfield Avenue 6279031	DISAGREE	This scheme is terrible. We drop our daughter at 8am to Caraousel Nursery (we cannot drop before as they have stopped early drop off due to COVID) and then we have to get to Sutton to drop our eldest to school within 20 mins. Restricting access to this road makes logistics for parents extremely hard and there has been no care but to enforce fines on us when we are just trying to get our kids to school and nursery and then get to work ourselves. Not everyone lives in walking distance to the school and not always is public transport the solution. you have implemented this without consulting the school or nursery on Aragon road and I think it is disgraceful.